

Charging Transformer for Padmount and Underground Switch Applications

The availability of charging voltage for a controller is sometimes a problem in establishing an automation location. 120 VAC may not exist at a padmount switch site and the nearest accessible source could be some distance away, requiring expensive trenching. To meet this need, Cleaveland/Price offers a compact voltage transformer that can be mounted within padmount switchgear or within a vault (submersible type).

The transformer is designed to meet demanding utility expectations. The primary and secondary windings and the high permeability directional core of the transformer are entirely encapsulated with silica-filled epoxy resin. Fault protection is provided by a replaceable 1 amp fuse. For maximum utility personnel safety, the transformer is encased in an aluminum or stainless steel housing and provided with a grounding terminal.

The transformer is available for high side voltages of 11.6 kV through 26 kV and has a secondary out voltage of between 112 V and 128 V. The transformer has an accuracy of 3% at rated burden of 800 VA (6.5 amps.). Dual primary voltage designs with 6% accuracy are available.

The charging transformer is tested and coordinated to work with Cleaveland/Price PAD and UAD controller electronics. The power output of the transformer is sufficient to provide continuous current for battery charging and heaters of a master controller and up to three drones as well as the RTU and radio loads of the master unit. The transformer can connect to the high voltage cable source with 200 amp dead break or load break elbow connectors. A 20 ft. long secondary output cable is provided.

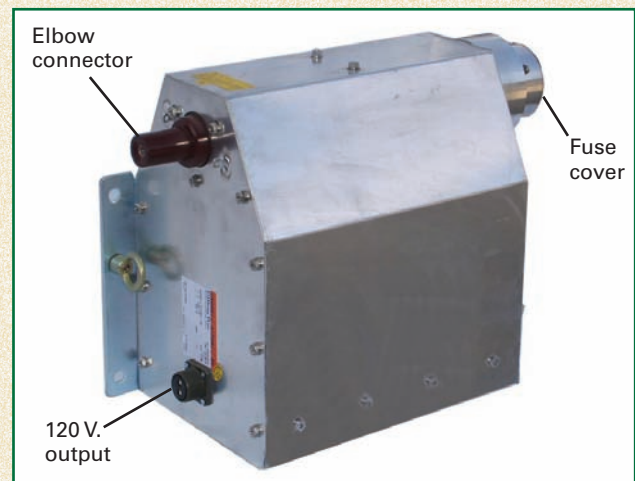

Charging transformer installed in a padmount switch.

 **CLEAVELAND / PRICE INC.**

14000 Rt. 993, Trafford, PA 15085 (724) 864-4177

FAX (724) 864-9040

Email: sales@cleavelandprice.com

Charging Transformer

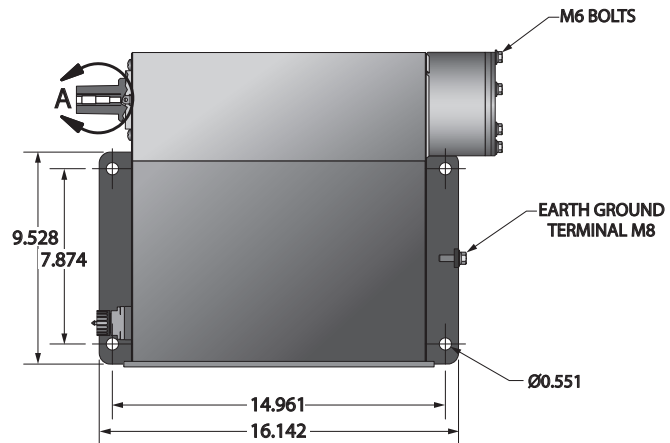
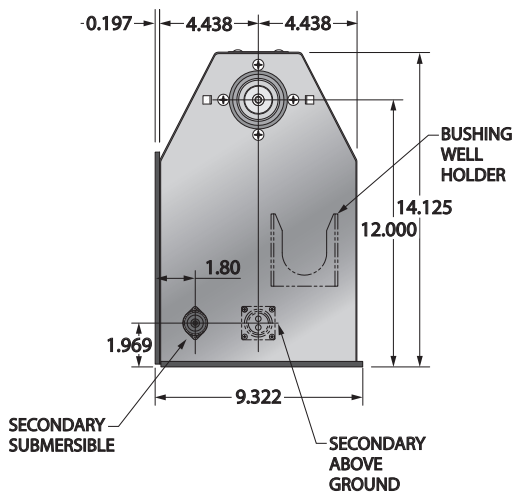
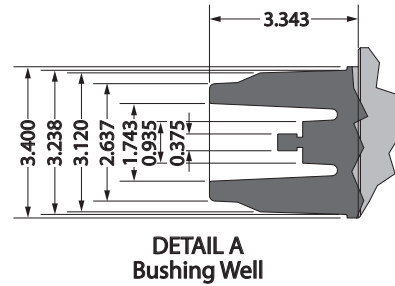
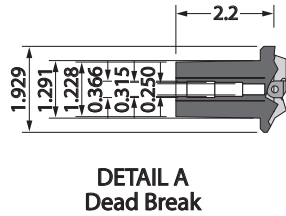
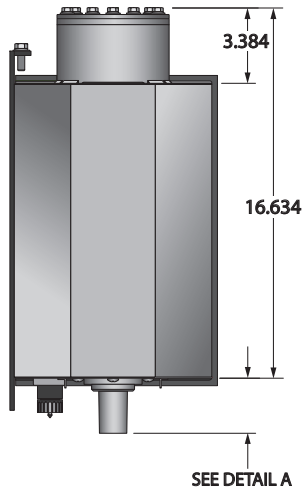

Catalog No.	Switchgear Voltage (L-L)*	BIL	Secondary Output	Submersible	High Side Connection Type	Weight
C128A710G01	11.6 kV – 13.3 kV	95	112 V – 128 V	No	Dead Break	132 lbs.
C128A710G02		95			Bushing Well	
C128A624G01		95		Yes	Dead Break	170 lbs.
C128A624G02		95			Bushing Well	
C128A711G01	12.9 kV – 14.8 kV	95		No	Dead Break	132 lbs.
C128A711G02		95			Bushing Well	
C128A627G01		95		Yes	Dead Break	170 lbs.
C128A627G02		95			Bushing Well	
C128A712G01	22.4 kV – 25.7 kV	125		No	Dead Break	132 lbs.
C128A712G02		125			Bushing Well	
C128A626G01		125		Yes	Dead Break	170 lbs.
C128A626G02		125			Bushing Well	

* Other L-L and dual primary voltage designs are available. Contact the factory for more information.